

NOTE: PIPE BLOCKOUT VARIES WITH PIPE SIZE, MATERIAL AND ALIGNMENT AND SHALL ALLOW 3" CLEAR FROM PIPE TO WALL

PRECAST INLET BOX RISER

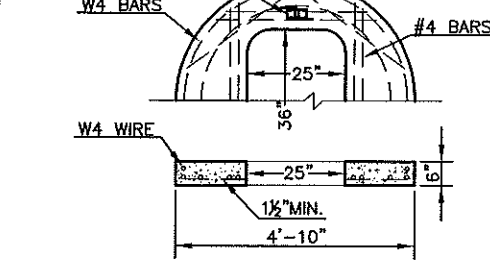
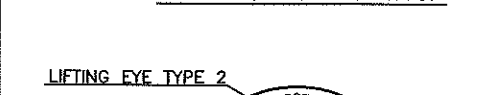
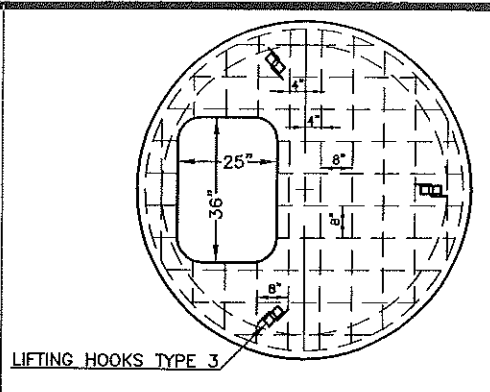

PRECAST INLET MANHOLE TOP NOTES

1. ALL REINFORCING SHALL BE #4 BARS EXCEPT AS NOTED
2. ALL CLEARANCE SHALL BE 1-1/2" EXCEPT AS NOTED

PRECAST INLET MANHOLE RISER NOTES

1. ALL MANHOLE RISER SECTIONS SHALL CONFORM TO A.S.T.M. 478-80.
2. ALL MANHOLE CONSTRUCTION SHALL BE WATERTIGHT.
3. STEPS SHALL BE PS1-PF OR PS2-PF AS MANUFACTURED BY M.A. INDUSTRIES INC. OF APPROVED EQUAL AND SHALL BE PLACED TO PROVIDE EASY ACCESS TO MANHOLE AT 18" O.C. MAX. WHILE MAINTAINING VERT. ALIGNMENT.

PRECAST INLET MANHOLE RISER & TOP

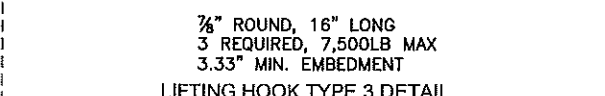
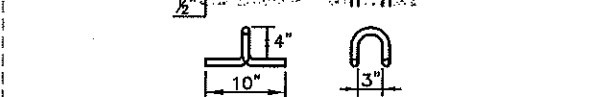
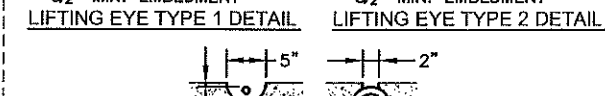
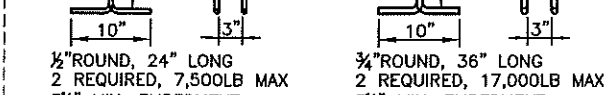
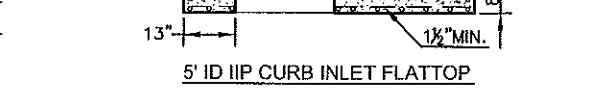
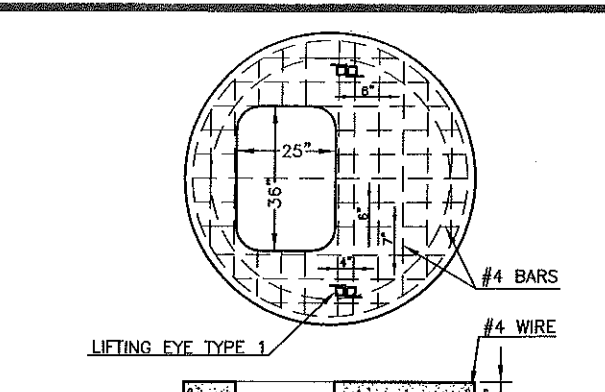

INLET POSITIONS WITH BACK OF CURB

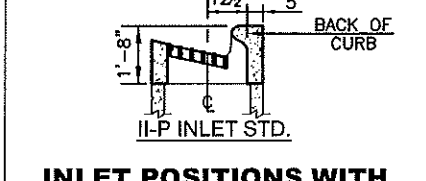
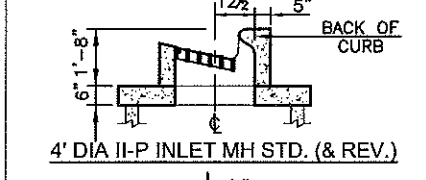
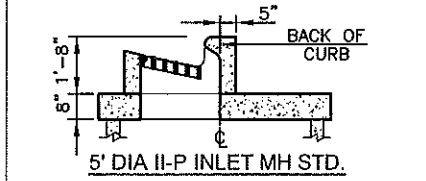
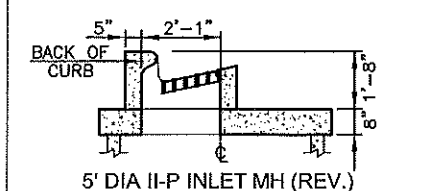
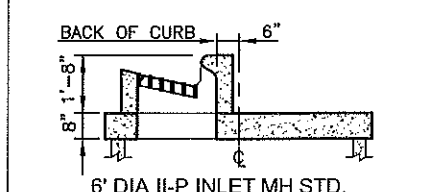
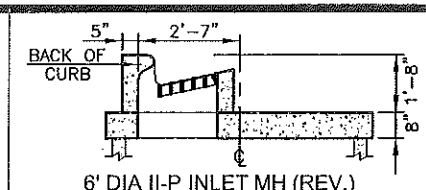

INLET DETAILS

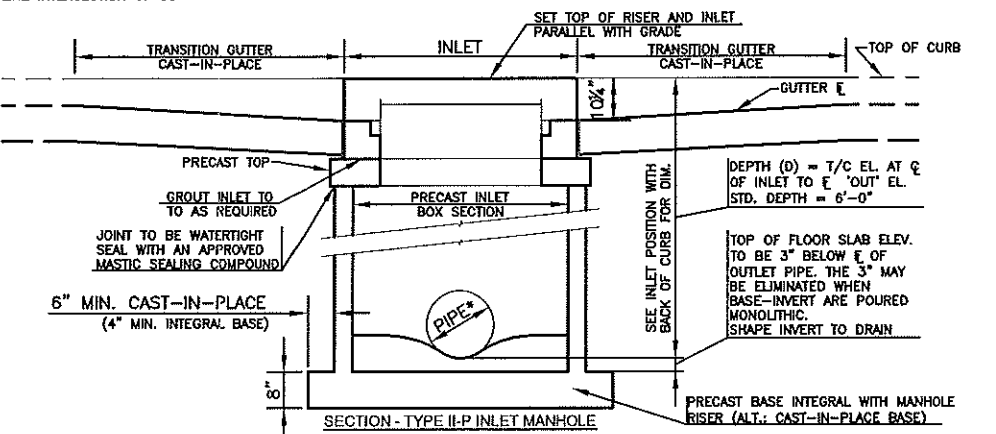
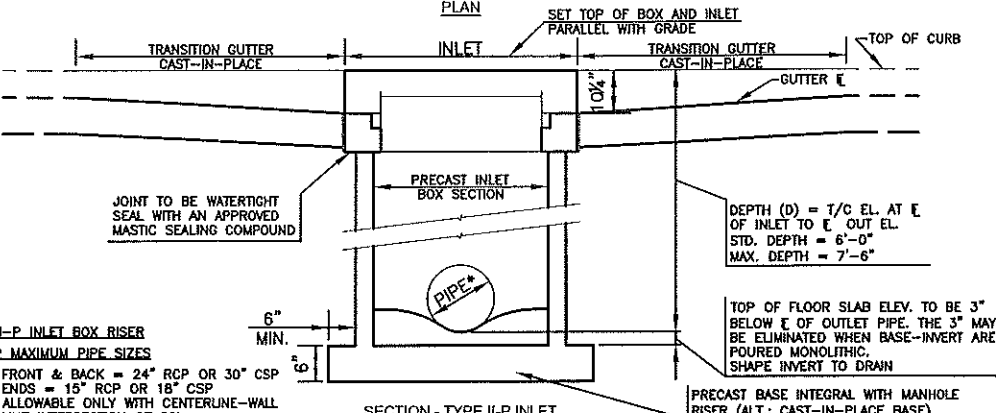
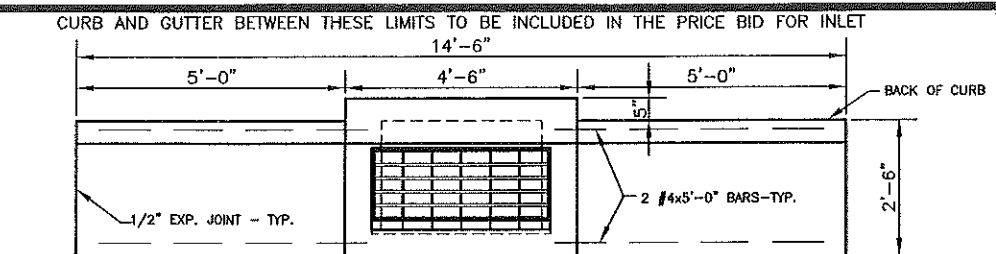

NOTE: THE BOTTOM SECTION OF ALL CAST-IN-PLACE MANHOLES AND PRECAST MANHOLES NOT BUILT MONOLITHICALLY WITH THE BASE SHALL BE SET INTO A STEEL REINFORCED (#4 @ 12" E.W.) CONCRETE BASE (4,000 PSI) A MINIMUM OF 4 INCHES. IN THIS CASE, THE BASE THICKNESS SHALL BE INCREASED BY 4 INCHES.

148 LB. PEDESTRIAN GRATE	
A	2 EA. 1/2" x 3x3x3'-1 1/2"
B	4 EA. 1/2" x 3x0'-3"
C	25 EA. 1/2" x 2x2'-1 1/2"
D	2 EA. 1/2" x 3x3x2'-1 1/2"
E	52 EA. 1/2" x 1x0'-1 1/2"
F	1-16" O.C.

250 LB. TRAFFIC GRATE	
A	2 EA. 1/2" x 3x3x3'-1 1/2"
B	4 EA. 1/2" x 3x0'-3"
C	12 EA. 1/2" x 3x2'-1 1/2"
D	2 EA. 1/2" x 3x3x2'-1 1/2"
E	26 EA. 1/2" x 1x0'-2 1/2"
F	2 1/2" O.C.

130 LB. YARD GRATE	
A	2 EA. 1/2" x 3x3x3'-1 1/2"
B	4 EA. 1/2" x 3x0'-3"
C	12 EA. 1/2" x 3x2'-1 1/2"
D	2 EA. 1/2" x 3x3x2'-1 1/2"
E	28 EA. 1/2" x 1x0'-2 1/2"
F	2 1/2" O.C.

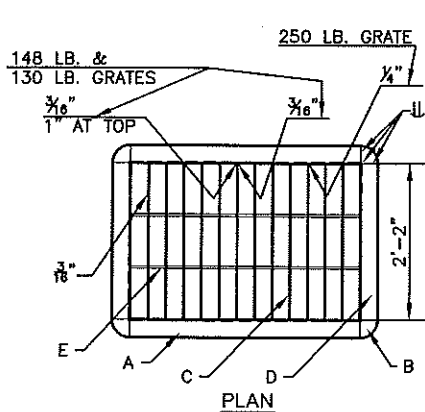

AREA INLET GRATE

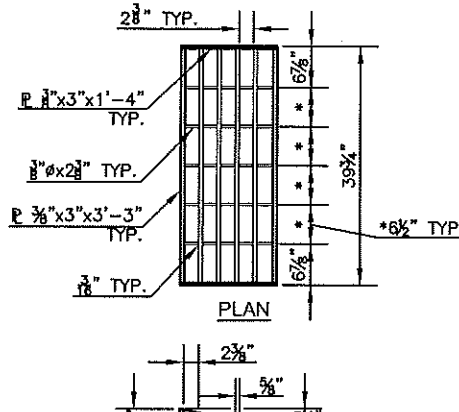

INLET GRATE
WEIGHT: 140 LBS

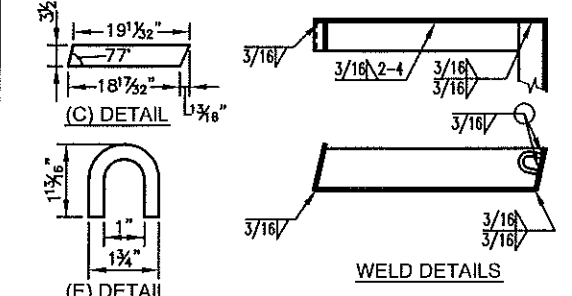

SYM	PCS	LENGTH	MATERIAL
A	2	4"	1/4x2 FLAT
B	2	18 1/2"	1/4x2 FLAT
C	2	18 1/2"	1/4x3.1/2 FLAT
D	1	40 1/2"	1/4x3.1/2 FLAT
E	5	4"	3/8 HR ROUND

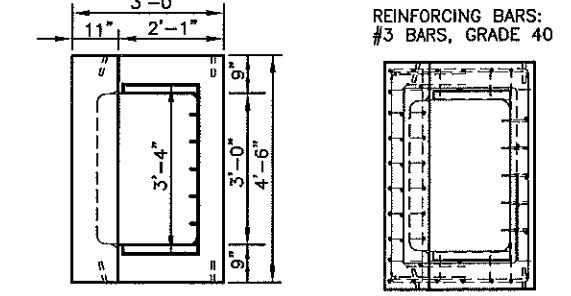

II-P CURB INLET
WEIGHT: 1,550 LBS

- REINFORCING BARS: #3 BARS, GRADE 40
- NOTES:
1. CAST IN PLACE CONC. SHALL BE 4000PSI.
 2. PRECAST CONC. SHALL BE 4000 PSI.
 3. REINFORCING WIRE SHALL CONFORM TO ASTM A82.
 4. REINFORCING BARS SHALL CONFORM TO ASTM A615.
 5. GROUT ALL PIPES IN PLACE.
 6. GRATES & FRAMES SHALL BE ASTM A36 STEEL COATED WITH BITUMASTIC BLACK SOLUTION (COAL TAR BASE) AS MANUFACTURED BY KOPPERS OR APPROVED EQUAL.
 7. THE INLET TOP SHALL SIT SQUARELY ON TOP OF THE INLET BOTTOM SECTION. THE INLET WALLS SHALL NOT BE OFFSET MORE THAN ONE INCH BETWEEN TOP AND BOTTOM SECTIONS.

NO.	DATE	REVISION	BY	APP'D
2	Dec. 2009	Mod. dim at Inl. Pos. & added 7.to NOTES	DHS	SB
1	Feb. 2008	Updote	DHS	SB

DRAWN BY: *mm/mc*
APP'D BY: *R. Clancy King*



SHAWNEE COUNTY, KANSAS
PUBLIC WORKS DEPARTMENT
1515 NW SALINE
TOPEKA, KS 66618
(785) 233-7702



STANDARD DETAILS

TYPE II-P INLET (PRECAST) (DT-011)

DATE: Month Year
SHEET: X of X
PROJ.: X-XXXXXX